



# SPIRAL090

MONOCOMANDO EMBUTIR DUCHE 1 VIA  
SPIRAL



A S M T A P S<sup>®</sup>

WATER SOUL

**EN** CONCEALED 1 WAY OUT SHOWER MIXER  
SPIRAL

**FR** MITIGEUR DOUCHE ENCASTRÉE 1 VOIE  
SPIRAL

**ES** MONOMANDO DUCHA EMPOTRAR 1 VIA  
SPIRAL

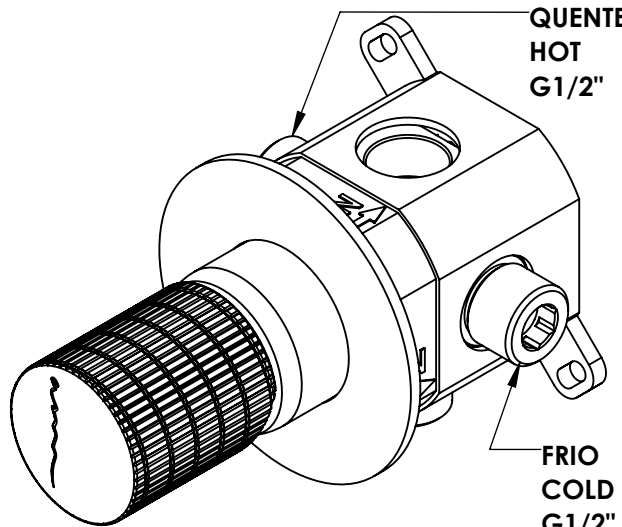
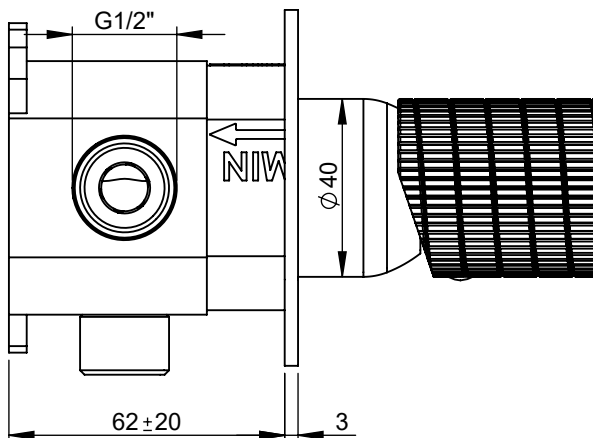
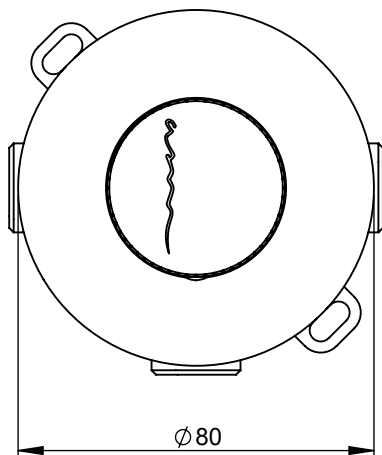

Rev. A 25/02/2026

SPIRAL090

## CARACTERÍSTICAS TÉCNICAS

**PRESSÃO RECOMENDADA:**  
RECOMMENDED PRESSURE: 3 - 4 BAR

**TEMPERATURA RECOMENDADA:**  
RECOMMENDED TEMPERATURE: 15°C - 65°C

**MATERIAIS:**  
MATERIALS: Latão

**TEMPERATURA MÁXIMA:**  
MAXIMUM TEMPERATURE: 70°C

**CAUDAL MÁXIMO A 3 BAR:**  
MAXIMUM FLOW AT 3 BAR: L/MIN

**LIGAÇÃO DE ENTRADA:**  
INPUT CONNECTION: G1/2"

**LIGAÇÃO DE SÁIDA:**  
OUTPUT CONNECTION: G1/2"

**PESO (KG):**  
WEIGHT (KG): 1,75

**DIMENSÕES EMBALAGEM (MM):**  
SIZE PACKAGING (MM): 250x90x100

## ACABAMENTOS

CR - CROMADO | CHROME | CHROME | CROMO

PR - PRETO MATE | BLACK MATT | NOIR MAT | NEGRO MATE

BR - BRANCO MATE | WHITE MATT | BLANC MAT | BLANCO MATE

ST - SATINOX | SATINOX | SATINOX | SATINOX

AT - ANTRACITE | ANTHRACITE | ANTHRACITE | ANTRACITA

GM - GUNMETAL | GUNMETAL | GUNMETAL | GUNMETAL

GMM - GUNMETAL MATE | GUNMETAL MATT | GUNMETAL MAT | GUNMETAL MATE

OR - DOURADO | GOLD | DORÉ | DORADO

ORM - DOURADO MATE | GOLD MATT | DORÉ MAT | DORADO MATE

CB - COBRE | COPPER | CUIVRE | COBRE

CBM - COBRE MAT | COPPER MAT | CUIVRE MAT | COBRE MATE

## TECNOLOGIA

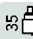
 AC540A - Cartucho Ø35  
AC540A - Cartridge Ø35

 Embutido a parede  
Built-in to wall

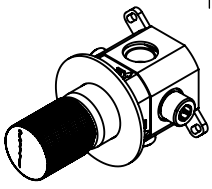

# SPIRAL090

MONOCOMANDO EMBUTIR DUCHE 1  
VIA SPIRAL



A S M T A P S<sup>®</sup>

W A T E R S O U L

## LISTA DE COMPONENTES

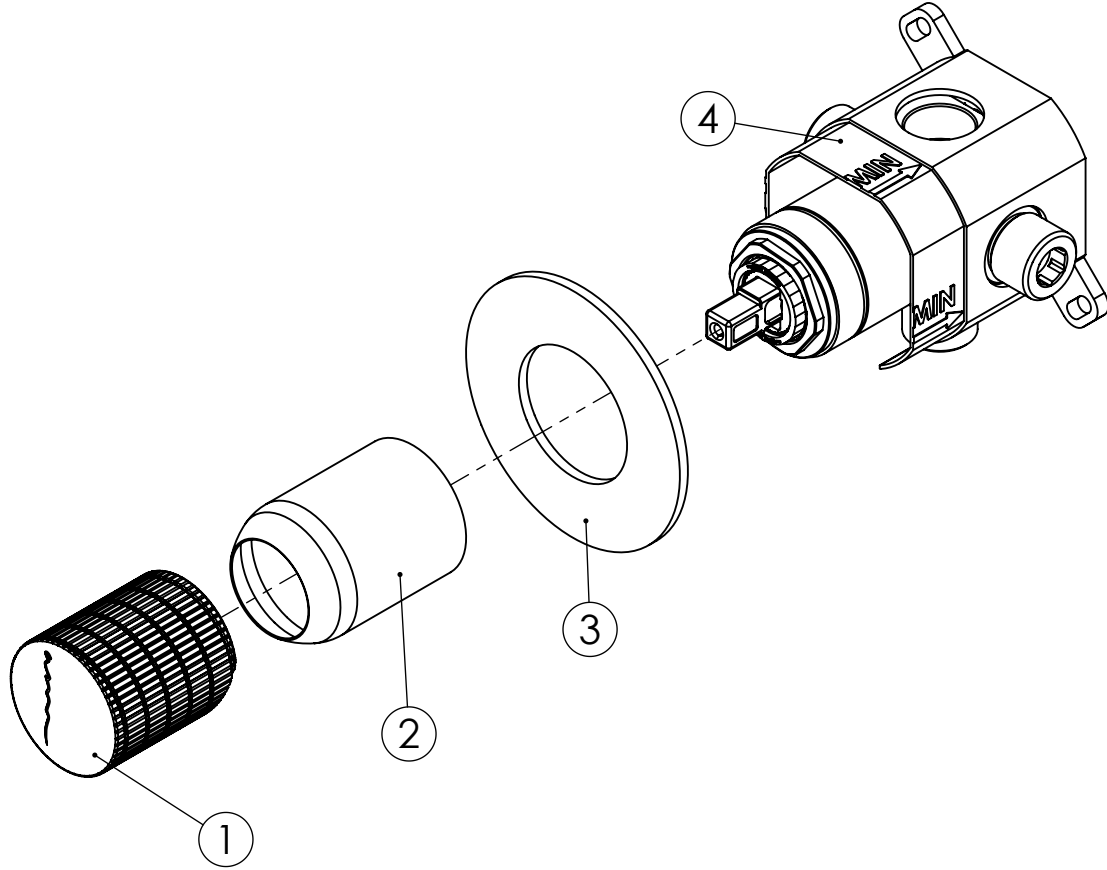

SPIRAL090 Rev.A 25/02/2026

Nº	DESCRIPTION	REF.	QT.
1	MANÍPULO SPIRAL LAVATÓRIO	AC2200	1
2	COPO EMBUTIDOS EXTERIOR	101557	1
3	ESPELHO 1 VIA CILÍNDRICO	100274	1
4	BOX MONOC.EMBUTIR LAVATÓRIO SEPARADO / DUCHE 1 VIA	INT102	1

# ! SERVICE

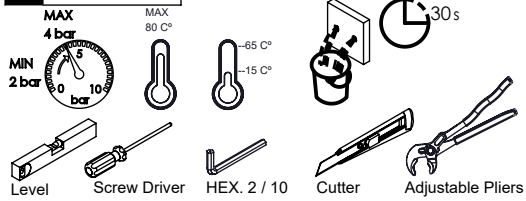

# SPIRAL090

## MONOCOMANDO EMBUTIR DUCHE 1 VIA SPIRAL



A S M T A P S ®

W A T E R S O U L

### INSTALLATION MANUAL

#### 1 CONECTION

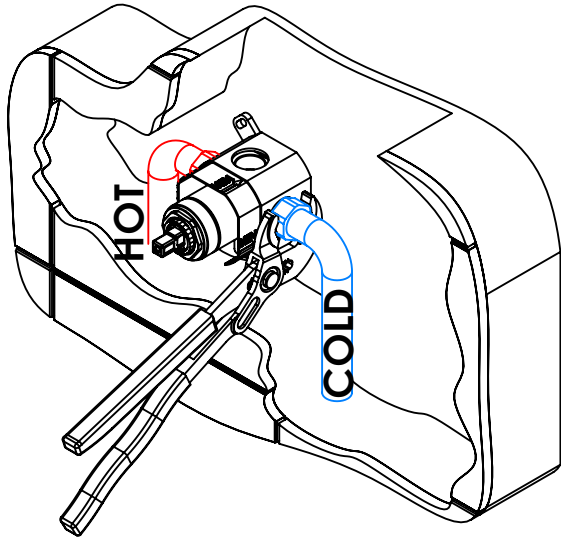

#### 2 FIXED

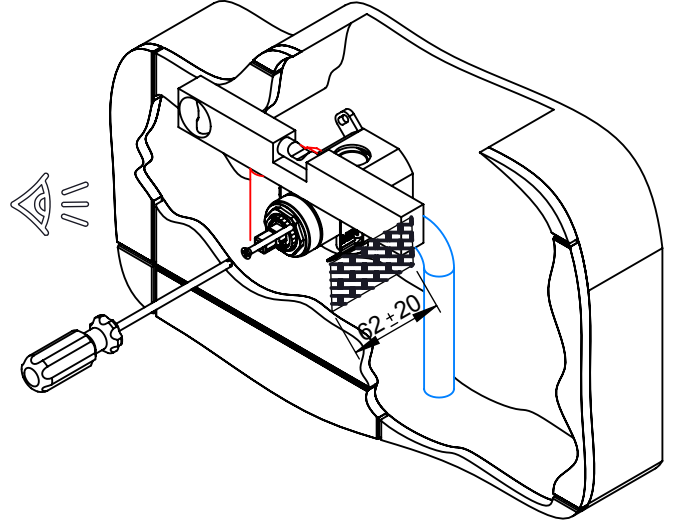

#### 3 CUT THE PROTECTION

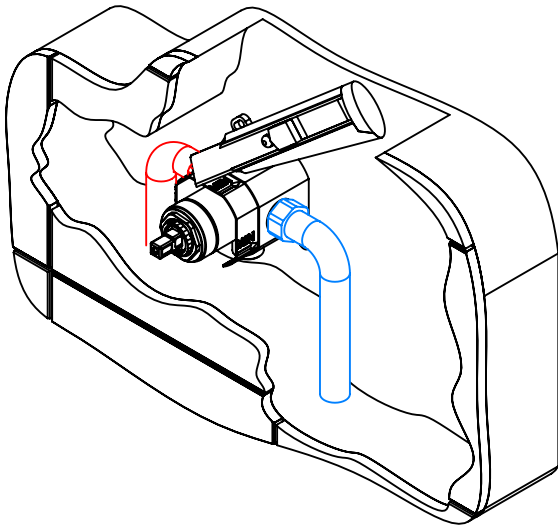

#### 4 FIX IT

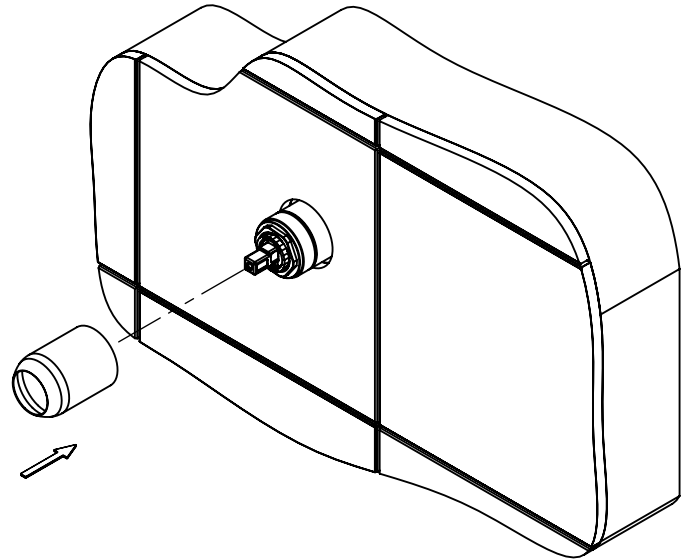

#### 5 FIX IT

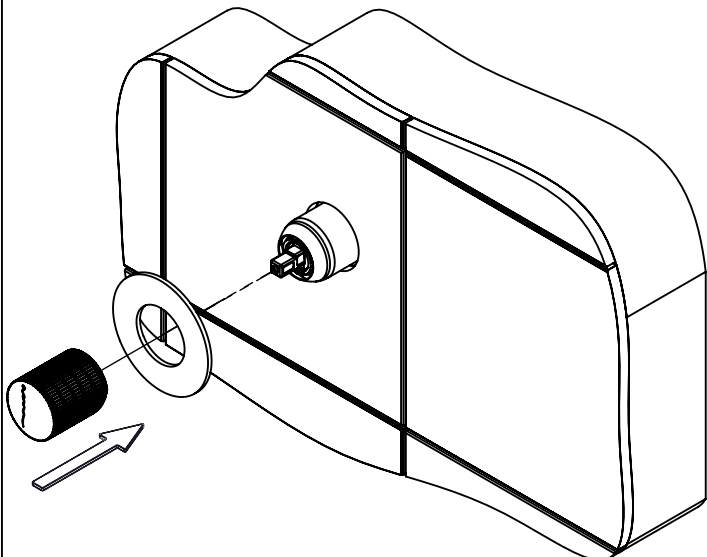

#### 6 MAINTENANCE

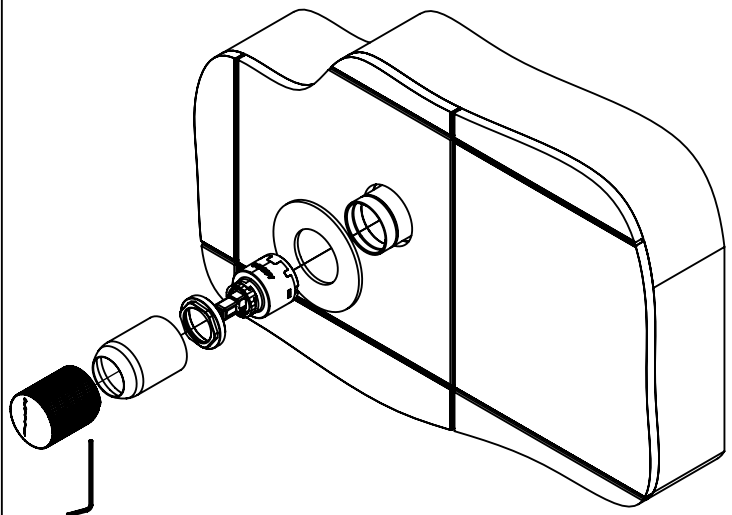

SPIRAL090 Rev.A 25/02/2026